

5.1 Data Sheet

		A	B	C	D
Screw Diameter	mm	65	70	75	80
Calculated Injection Volume	cm ³	1068	1239	1423	1619
Injection Capacity(PS)	g	972	1127	1295	1473
Injection Rate	g/s	349	405	464	528
Plasticizing Capacity(PS)	g/s	58.6	67.3	76.1	84.4
Injection Pressure	MPa	213	184	160	141
Injection Stroke	mm	322			
Screw Speed	r/min	0~220			
Heating Input Power	KW	36.4			
Clamping Force	KN	4500			
Space Between Tie-Bars(H×V)	mm	810×800			
Die-Height Available (Max.)	mm	850			
Die-Height Available (Min.)	mm	350			
Mold Opening Stroke	mm	550/1050			
Open Daylight	mm	1400			
Ejector Stroke	mm	250			
Ejector Force	KN	110			
Ejector Number	PC	13			
Pump Motor Power	KW	55+4			
Oil tank Capacity	l	720			
Machine Dimension(L×W×H)	m	7.3×2.4×2.5			
Total Machine Weight(approx.)	t	20			
Minimal Mold Dimension(L×W)	mm	567×560			
Die parallelism	Die height	≥550—630mm	μm	80	
		>630—1000mm	μm	100	
		>1000—1450mm	μm	120	

5.2 Mould Mounting Dimensions

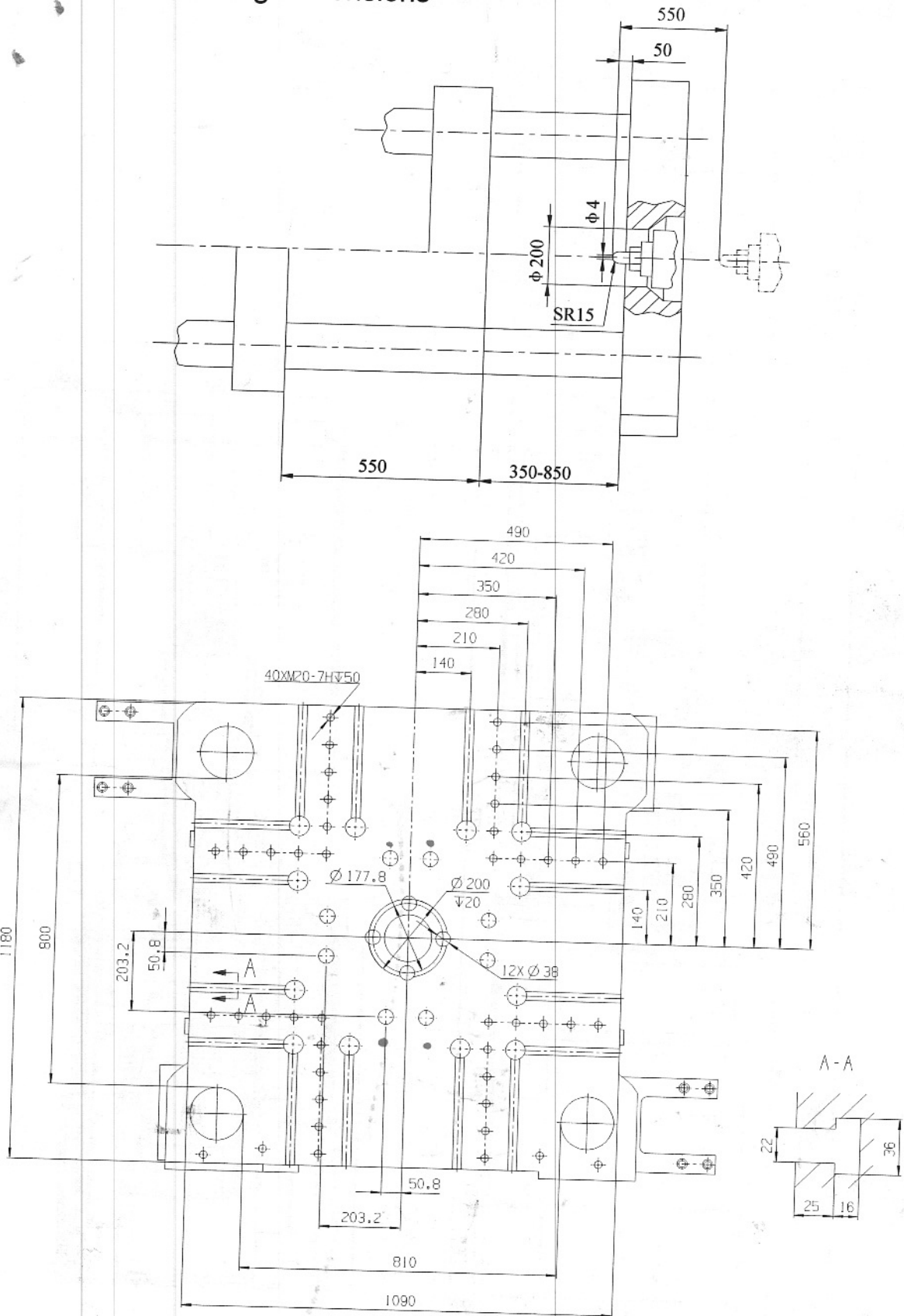

Designed/Date: Zhou Fei 151126

Checked/Date: Wu Jun 151126

JU4500 II